

1. Package and Product Parameters

Package Contents:

Watch Phone Z1	1	Charging Cable	1
Manual	1	SIM Card Picker	1

Product Parameters:

Product: Watch Phone
Model: W1923AO/W2123AO
Battery: Lithium Polymer Battery 3.85V 740mAh
Camera: 2MP
Charge Input: DC 5V 1200mA
Working Temperature: 0℃~35℃
Working Humidity: Noncondensable 15%~93%
Network Frequency Band:
W1923AO: 2G GSM 900/1800MHz
3G WCDMA B1/B5/B8
4G FDD-LTE B1/B3/B5/B8
4G TDD-LTE B38/B39/B40/B41
W2123AO: 2G GSM 900/1800MHz
3G WCDMA B1/B5/B8
4G FDD-LTE B1/B3/B5/B8
4G TDD-LTE B34/B38/B39/B40

2. Device Layout

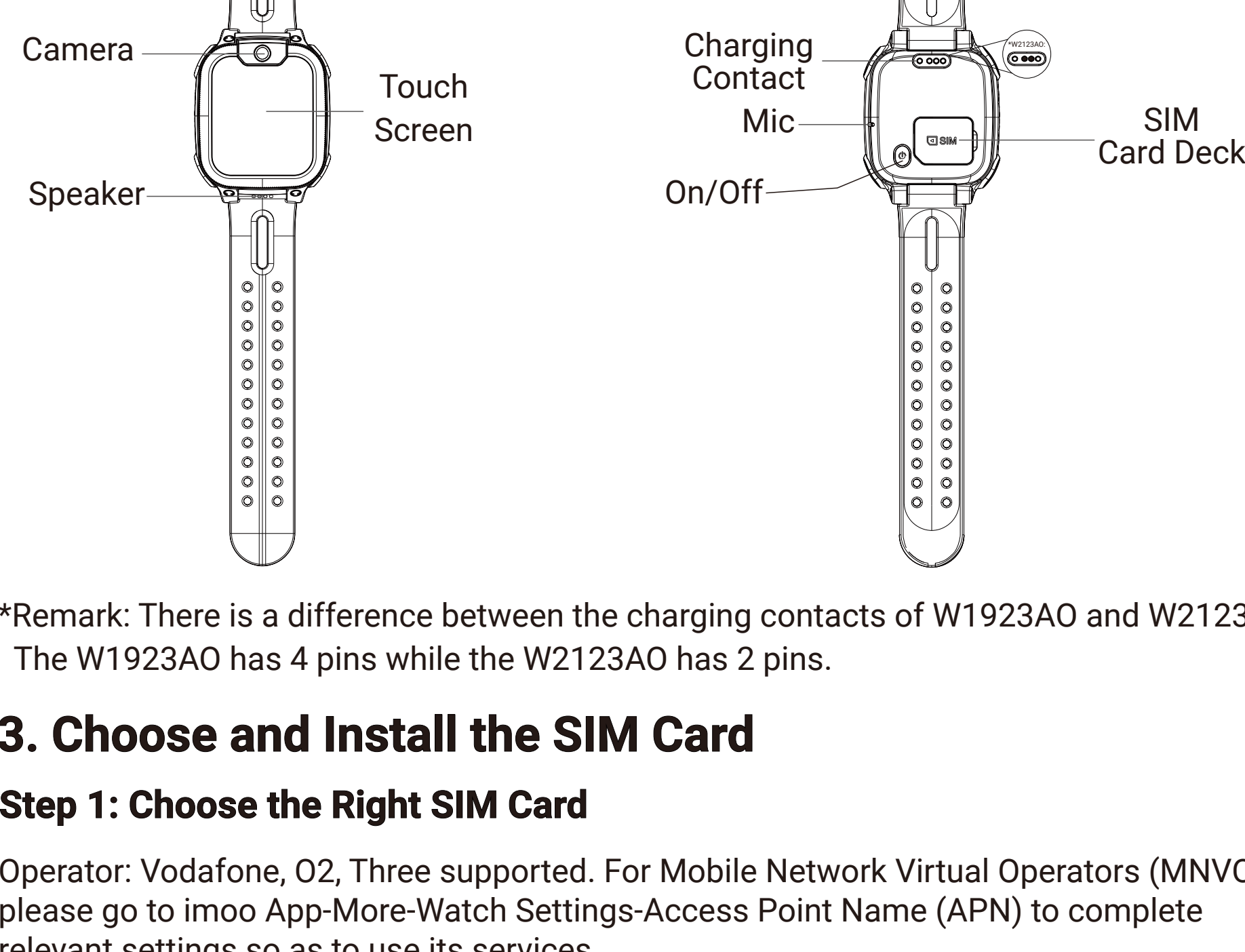

*Remark: There is a difference between the charging contacts of W1923AO and W2123AO. The W1923AO has 4 pins while the W2123AO has 2 pins.

3. Choose and Install the SIM Card

Step 1: Choose the Right SIM Card

Operator: Vodafone, O2, Three supported. For Mobile Network Virtual Operators (MNVO), please go to imoo App-More-Watch Settings-Access Point Name (APN) to complete relevant settings so as to use its services.
The Size of SIM Card: supports Standard Nano-SIM card only [as picture (1)].

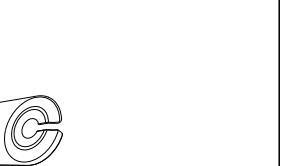

Step 2: Activate “Caller ID” function & data plan

Please activate “Caller ID” function and enable GPRS data network. Watch phone can access to either 2G/3G/4G network data.

Step 3: Install the SIM Card

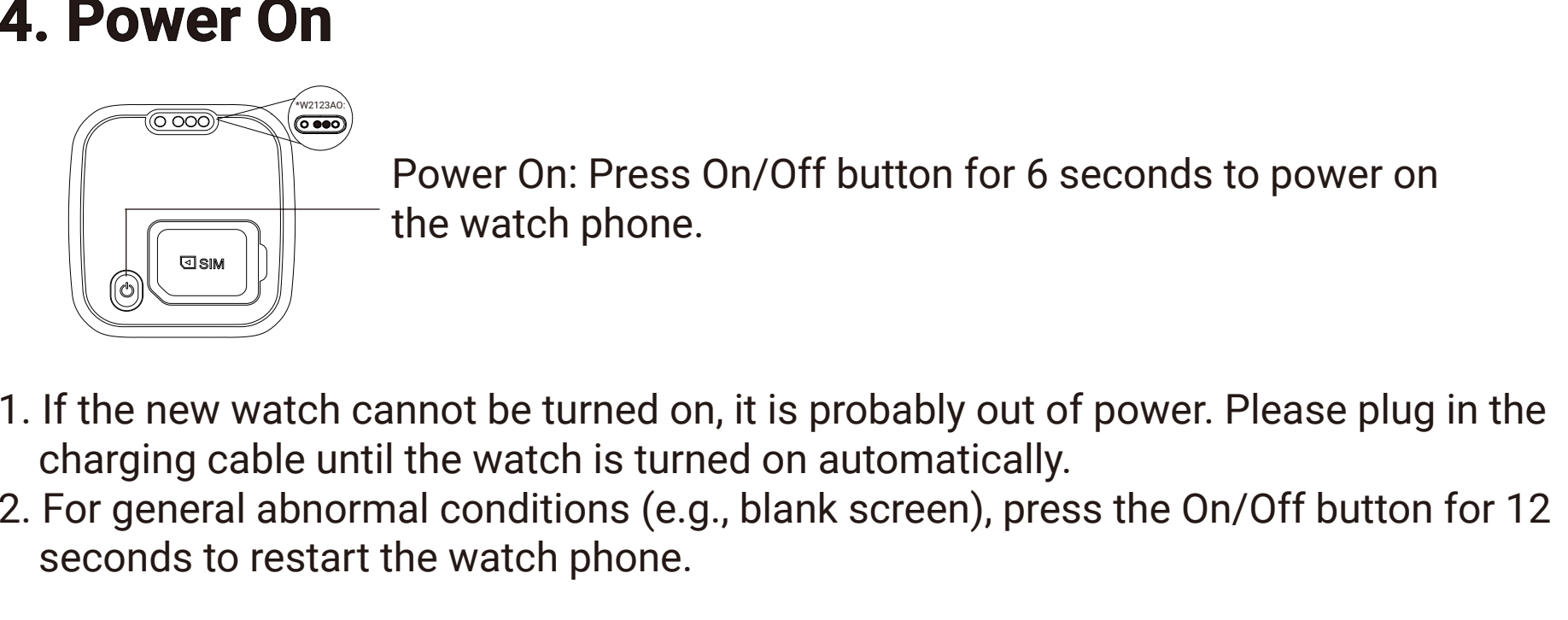

4. Power On

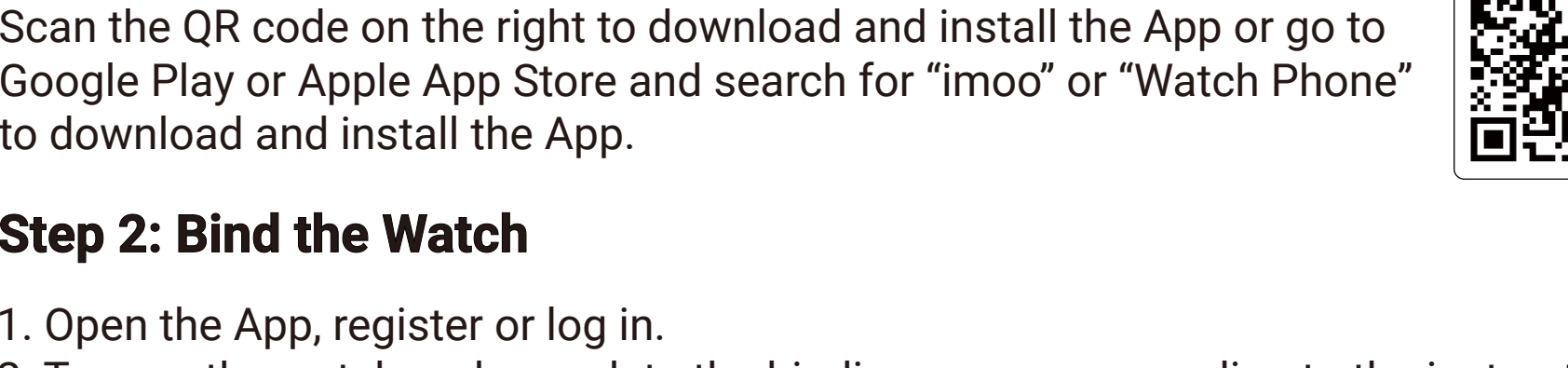

- If the new watch cannot be turned on, it is probably out of power. Please plug in the charging cable until the watch is turned on automatically.
- For general abnormal conditions (e.g., blank screen), press the On/Off button for 12 seconds to restart the watch phone.

5. Download the App & Bind the Watch

Step 1: Download & Install the App

Scan the QR code on the right to download and install the App or go to Google Play or Apple App Store and search for “imoo” or “Watch Phone” to download and install the App.

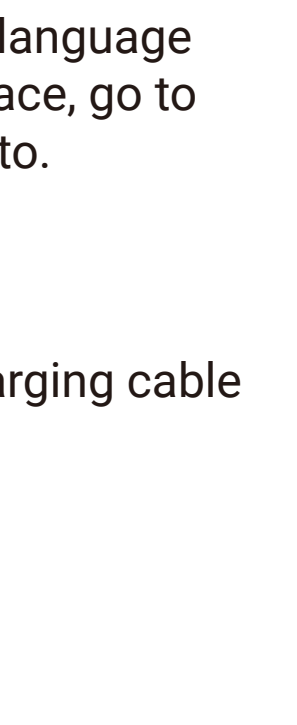

Step 2: Bind the Watch

- Open the App, register or log in.
- Turn on the watch and complete the binding process according to the instructions displayed on the watch, or slide the watch interface to find the Bind Code, scan the QR code, or manually enter the Bind Code for binding.

Get the Bind Code:

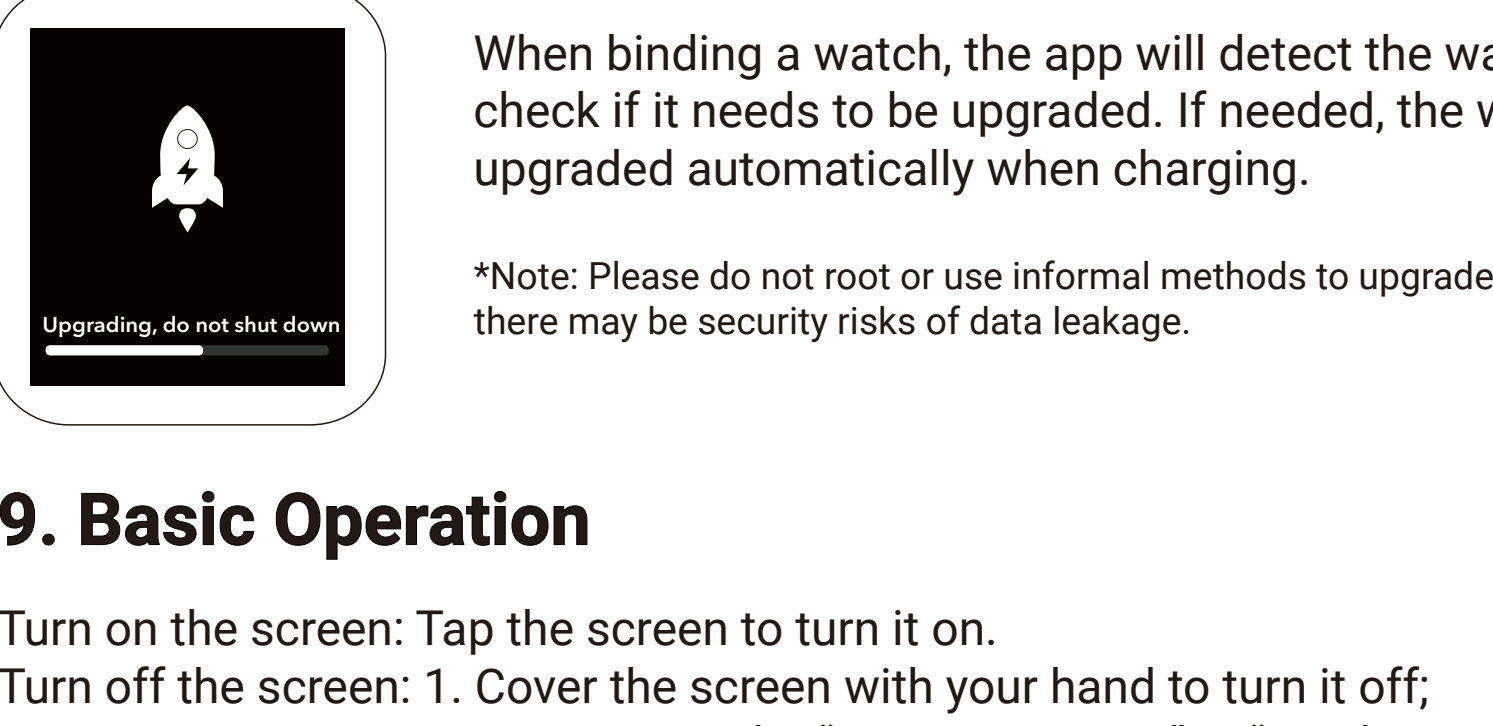

6. Watch Language Settings

Go to “More-Watch Settings-Watch Language” on imoo App to switch the language you'd like to switch to; or go to your watch, swipe left from the main interface, go to “Settings-Language Selection” to switch the language you'd like to switch to.

7. Charge

Align the charging contactors on the watch with the contactors on the charging cable until “Charging...” is displayed on the screen.

* Please use the CE certified power adapter.

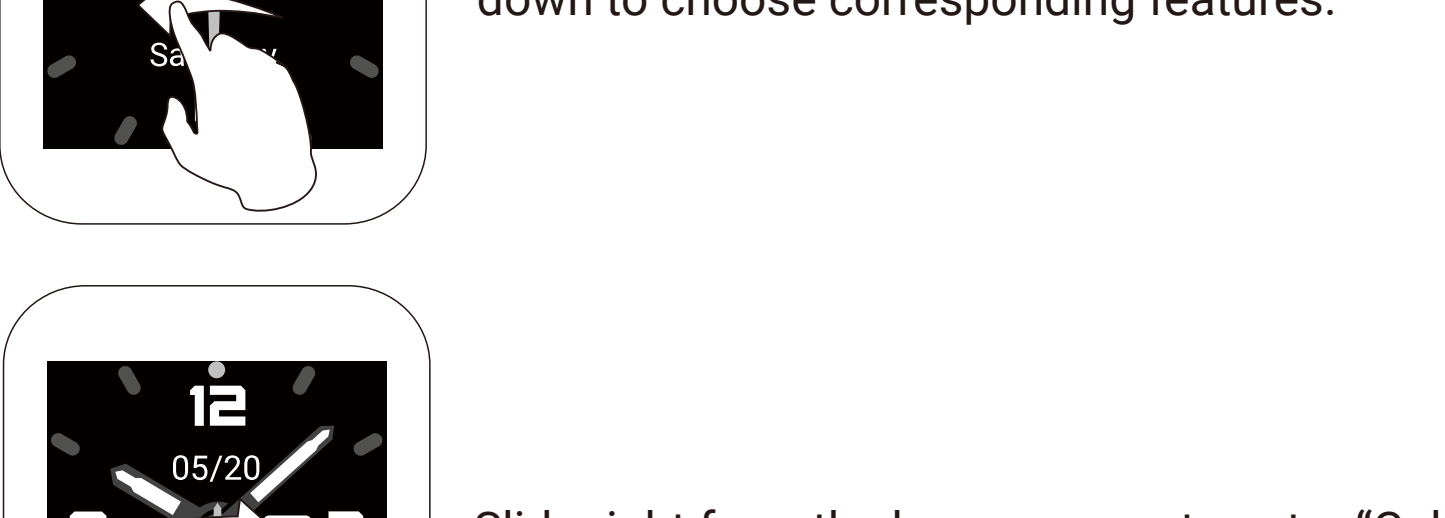

8. OTA Upgrade

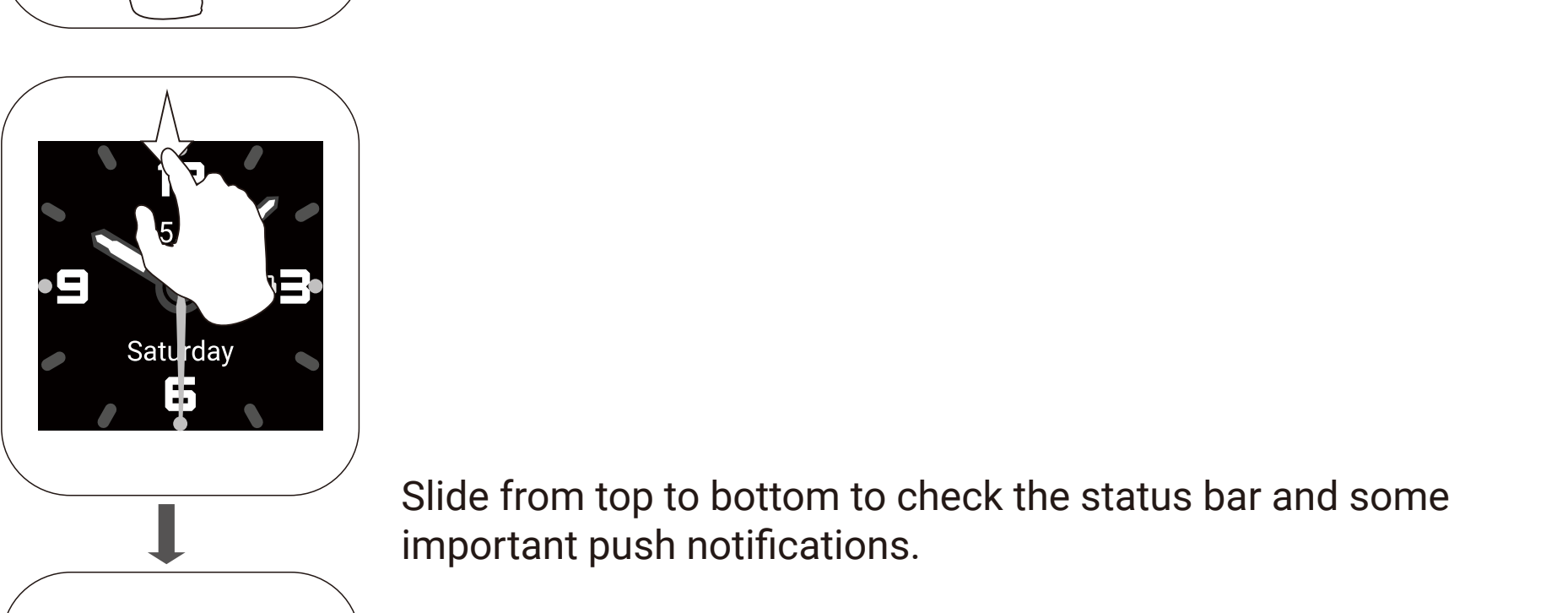

9. Basic Operation

Turn on the screen: Tap the screen to turn it on.

Turn off the screen: 1. Cover the screen with your hand to turn it off;
2. You can set the “Screen Timeout” in “Display & Brightness” of the “Settings” on More interface. When the time is up, the screen will be turned off.

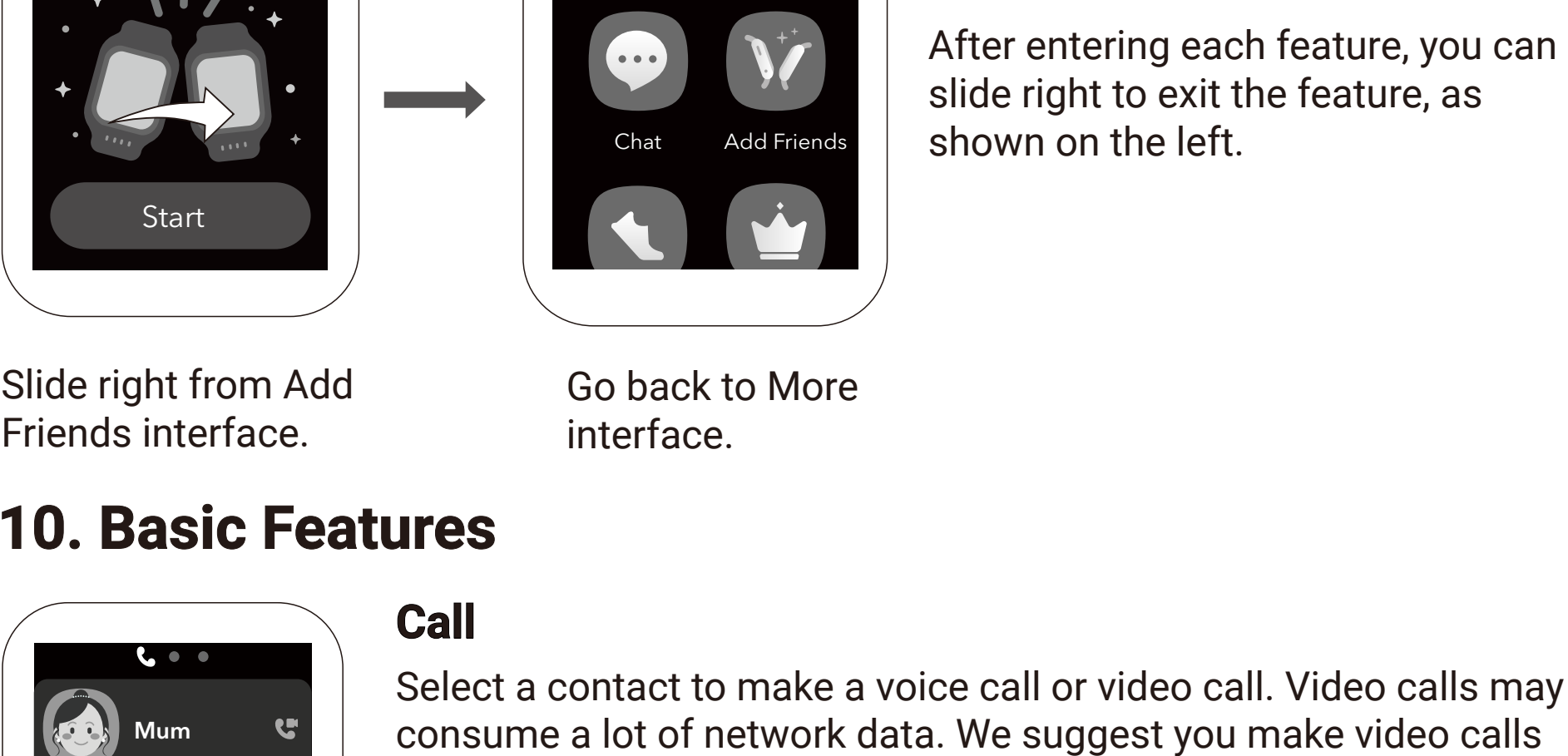

10. Basic Features

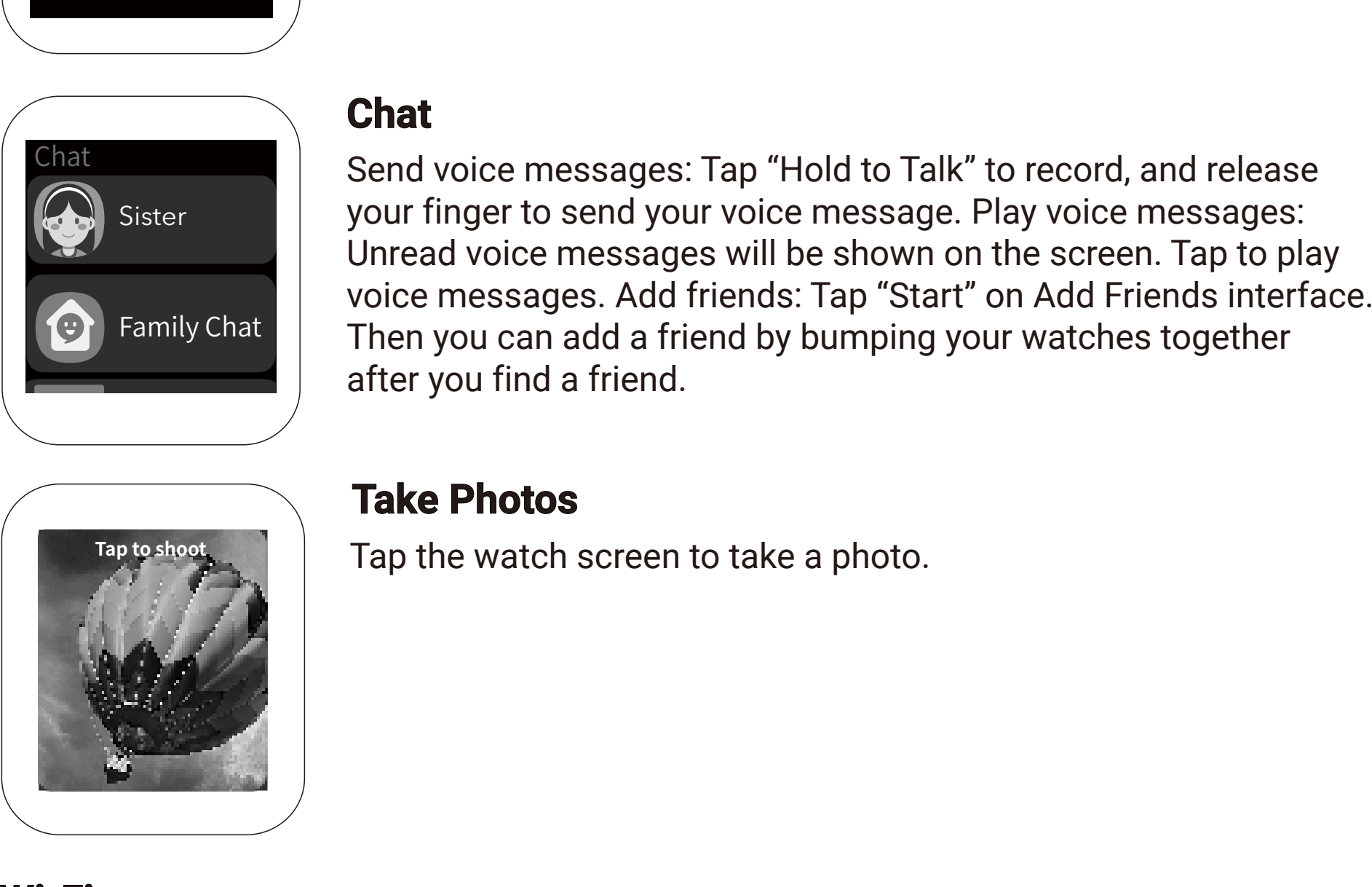

Wi-Fi

Go to your watch's “More-Settings-WLAN” to set the Wi-Fi connection. After binding your watch, enter “More-Watch's networks” on App to add a network.

11. Appendix: Specifications

	Specifications
Dimension	51.1×41.7×14.5 (mm)
Color	Grapefruit Red/Bamboo Green
Screen	1.3 inches TFT (240×240)
Network	W1923AO: 2G GSM 900/1800MHz 3G WCDMA B1/B5/B8 4G FDD-LTE B1/B3/B5/B8 4G TDD-LTE B38/B39/B40/B41 W2123AO: 2G GSM 900/1800MHz 3G WCDMA B1/B5/B8 4G FDD-LTE B1/B3/B5/B8 4G TDD-LTE B34/B38/B39/B40
VoLTE	Supported
CPU	Spreadtrum UWS6131E
Sensor	Accelerometer
Memory	RAM: 128MB ROM: 128MB
Connectivity	WiFi: TX/RX: 2412-2472MHz, Bluetooth 4.2
Rated Output Power	W1923AO: GSM900: (33dBm±2dB) GSM1800: (30dBm±2dB) WCDMA B1/B5/B8: 24dBm(+1.7/-3.7dB) FDD-LTE B1/B3/B5/B8: 23dBm(±2.7dB) TDD-LTE B38/B39/B40/B41: 23dBm(±2.7dB) WiFi<20dBm W2123AO: GSM900: (33dBm±2dB) GSM1800: (30dBm±2dB) WCDMA B1/B5/B8: 24dBm(+1.7/-3.7dB) FDD-LTE B1/B3/B5/B8: 23dBm(±2.7dB) TDD-LTE B34/B38/B39/B40: 23dBm(±2.7dB) WiFi<20dBm
Operation System	Mocor OS
Locating Technology	GPS, GLONASS, WIFI, LBS
Battery	740mAh
In the Box	Watch Phone Z1, Charging Cable, Manual, SIM Card Picker

12. Statements

- Please read this manual carefully so that you can use this product correctly and safely.
- Please use the watch strap that is well matched with this product to avoid affecting the watch's antenna signal. The use of other straps may result in poor call quality and locating failure.
- This product is equipped with GPS locating, which is disabled until the watch is bound. The watch's location can be obtained once the watch has been bound and the permissions to the watch's location data has been given.
- The outdoor locating of this product may fail because of failure in searching satellite signal in inclement weather.
- Please use the accessories that come with the package only. If the user does not use this product in a correct way and connects it with incompatible accessories, it will cause the automatic invalidation of the warranty and may cause irreparable damage to the product, or even endanger the safety of your children and you. For the cases mentioned above, we bear no liabilities.
- If you need to replace accessories, please buy them from our official service center only.
- The color of the watch and its strap may fade over time, which will not affect the use of the product and is harmless to human body.
- If you disassemble the case of this product without authorization, the product will no longer enjoy the warranty service.
- This product works normally with smooth network connection only. We bear no liabilities for any loss caused by interruptions in service due to network failure or any other force majeure.
- We reserve the rights to modify and improve any product details described in the document without prior notice for the purpose of constant improvement and sustainable development. The contents stated in this manual are provided based on the conditions when the products are manufactured. Unless otherwise indicated, we do not guarantee the accuracy, reliability and the contents of the documents, either expressed or implied.
- To the maximum extent permitted by applicable laws, in no event, whatever the cause, shall our suppliers and we be liable for any special, incidental, consequential or indirect loss or damage.
- Some features of this product (including but not limited to Maps) are provided by third parties.
- This manual contains important information, which should be kept properly.
- This product is not equipped with the monitoring feature.

13. Attentions

Please read the following contents and attentions carefully before using this product, and abide by them when using it. We bear no liabilities for the consequences caused by the failure in using this product correctly or abiding by the relevant instructions of this product.

Attentions for Operation Place and Environment:

- Any radio transmission device (including this product) may interfere with the medical device that is not properly protected and please observe the relevant regulations of the places where wireless transmission of electronic equipment is prohibited.
- Pacemaker and implanted cardioverter defibrillator: Keep the distance between the watch and the instrument greater than 6 inches (about 16cm) each time you turn on your watch. Do not put your watch in your clothes pocket. Please use the watch on the other side of the instrument to reduce potential interference. If you suspect that interference has occurred, turn off your watch immediately.
- Hearing aids and implanted cochlea: Some wireless digital devices may interfere with some hearing aids or implanted cochlea. If this type of interference occurs, please contact the manufacturer to find a solution.
- For other medical equipment, check with the manufacturer to confirm whether the surrounding RF signals can be adequately shielded. You can also consult your doctor for the relevant information.
- It is strictly prohibited to use this product in petrol stations, fuel warehouse, chemical plants or facilities transporting or storing chemicals to avoid explosions or fire disasters.
- Please power off this product before taking off.
- Please abide by all the relevant regulations and never use this product in a place where blasting is carried out.
- All wireless devices can be subject to interference, which can have an impact on performance.
- Never put the product, battery and its charger (charging cable) in or around the heating equipment or high voltage equipment (e.g., microwave oven, oven, radiator, electric heater, etc.), otherwise, it may cause damage to circuit, fire, explosion and other accidents.
- Never allow children or pets to swallow this product or its accessories to avoid injury.
- It is strictly prohibited to use this product in dusty, damp, dirty places or places close to magnetic field.
- It is strictly prohibited to use this product in thunderstorm weather.
- Never impact or vibrate this product and its accessories forcefully to avoid damage.
- Do not use the watch speaker against your ear, as it may cause hearing damage due to excessive volume.
- When using a power-hungry application or using applications on the device for a long time, it is normal that the device is warm to the touch, and it will not affect the performance or service life of the device.
- If the watch is getting hot, stop using it until it cools down. Low-temperature burns such as red spots and pigmentation may be caused if the skin contacts the device with extremely high temperature in the long run.
- If parts (e.g., watch straps, strap fixing rings, clasps, etc.) need to be replaced, please operate by an adult, and never allow children to touch the parts so as to prevent children from accidentally swallowing small parts, which may lead to suffocation or other dangerous situations.
- Please use the parts of the product correctly according to the manual, and do not use them for other purposes.

Maintenance:

- Non-professionals are not allowed to disassemble the watch and other accessories without authorization. For any faults with the watch and its accessories, please contact imoo's official after-sales service center.
- Never clean this product with chemical solvent or cleaning agent.
- Prevent the watch from falling and avoid knocking, vibrating or roughly treating the watch, which may lead to damage to the screen, internal circuit board and precise structure.
- For any abnormalities during use, long press the On/Off button until the watch is restarted. General abnormalities can be solved in this way.
- To prolong the service life of the battery, please keep the battery level above 80%. The charged battery left unused for a long time will gradually discharge itself. When it is not in use, please place it in a cool, dry and dark place after charging.
- The cleanliness of the watch strap is not a constant feature, it is related to the environment in which the user used and user's habits. The watch strap is in direct contact with the skin, so it must be clean. If the strap is stained with perspiration, dust or other stains, wipe it with a clean, dry and soft cloth.
- If the charging contactors on the watch are dirty, clean them with a dry and soft cloth, and do not scratch them with hard metal objects.
- If the watch strap is old or worn out and needs to be replaced, please entrust your dealer or our after-sales service center to replace it. Please note that even if the watch is under warranty, you still need to bear the replacement cost of the strap.
- Power off the watch before cleaning it.
- Do not clean the watch while charging.
- Do not use hair dryers or other heating methods to keep the watch dry.
- Do not use pressurized air guns, washing machines or other mechanical tools to clean the watch.

Attentions for Charging and Battery Use:

- The volume of the watch decreases gradually as the voltage decreases.
- Due to the consideration of environmental protection, this product is not equipped with a power adapter. You can use the USB interface of your computer or the power adapter with CE certification to charge. And the output voltage and current of the power adapter should conform to the following specifications: output DC voltage: 5V; output DC current: No less than 1200mA.
- Please buy the power adapter with quality assurance. Poor-quality or counterfeit power adapters may cause an explosion or fire.
- The power adapter is a disconnecting device, the power outlet should be installed nearby for convenient disconnection. When repairing or disassembling the watch, please unplug the power adapter from the outlet.
- Please ensure that charging contactors are dry and without dirt before charging.
- Never throw the battery into fire or expose it to an overheated environment such as sun, roasting with fire or similar conditions to avoid leakage, overheating, explosion or fire disaster.
- Please replace the battery with a new one with the same or equivalent type to avoid explosions.
- This product is equipped with a built-in battery. It is strictly prohibited to dismantle, squeeze, heat or burn the battery. It's also strictly prohibited to touch or pry the battery with sharp objects and screwdrivers since all the operations mentioned above may cause fire or combustion of the battery.
- If the battery is overheated, discolored, out of shape, bulged or weeping during use, charging, or storage, stop using and replace it with a new one to avoid security issues.
- When charging, since the temperature of the battery will rise, please do not put the battery together with combustible materials (such as bedding, clothes and books) to avoid fire.
- Do not use or store this product in the environments of high temperature, high pressure, humidity, or strong magnetic field.
- Please charge the watch at 5℃-35℃ to avoid degradation in battery performance and reduction in standby time.
- To prevent children from getting an electric shock, please charge the watch under the guidance of parents or other guardians.

 Caution: There may be a risk of explosion if the battery is not replaced in the right way.

Attentions for SIM Card and Charging Cable Use:

- When installing/removing the SIM card or connecting the charging cable to the charging contactors, make sure that the SIM card is correctly installed or the charging cable is correctly connected, do not insert the SIM card or connect the charging contactors to the charging cable forcibly.
 - Do not remove the SIM card when the watch is transferring or accessing data, otherwise, it will cause data loss or damage to the SIM card.
 - The watch will actively connect to the data network to synchronize with the server in a discontinuous manner under working conditions (Data connection will not be actively requested under test).
 - Please activate the caller ID feature of the SIM card. The watch will consume a certain amount of data during normal use and upgrade. Please make sure that the SIM card has sufficient call charges and data before use. As for the call charges and data charges incurred when using the SIM card, please refer to the operators' charging standards.
- #### Wearing Instructions:
- When wearing a watch, please adjust the tightness of the watch strap. It should not be too tight so as to provide a breathing space for the skin. Also, it should not be too loose so as to prevent the watch from falling or damage due to falling.
 - Try to avoid flushing the watch or wearing a watch in the shower; Otherwise, the watch may be damaged.
 - If the volume of the watch decreases after being soaked with water, remove the water from the speaker hole and the volume will return to normal.

People Prone to Skin Allergies:

- People with sensitive physical constitution may feel uncomfortable when wearing wearable devices, should take extra caution when using this product.
- If you feel uncomfortable, it may be caused by wearing too tight or wearing for a long period of time. It is recommended that you adjust the strap tightness or wear the watch with the other hand and observe.
- Stop using the watch immediately and consult a physician if you experience redness, swelling, itching, or other discomforts on the skin around or under the watch.
- Continuing to use after recovering may cause a recurrence or increased discomfort.
- If you need to replace the watch strap, please purchase it from our official sales branches, as straps purchased from informal channels may cause skin allergies.
- We are not responsible for any personal discomfort caused by special physical conditions.

Statement of Water Resistance:

- The water resistance level of the watch is IPX8 of the IEC 60529:2013. It's splash and spill resistance (e.g. it can be worn while washing hands, in the rain, etc.).
- The watch has been tested in the laboratory under the test conditions of 15-35℃, 86-106kPa, soaked under the water level of 2 meters for 1 hour. Although the watch has been tested and met the relevant requirements, it does not mean that the watch will not be damaged by water under any conditions.
- If the watch is exposed to liquid, please send it to imoo's official after-sale service center for testing timely. The warranty service will not be honored for the watch being damaged by liquid due to human factors (non-normal use).
- The watch's water resistance is not a constant property. To ensure that the watch works well, please observe the following tips:
 - Do not wear the watch when taking a shower, taking saunas, swimming, taking steam saunas (or in steam rooms) or bathing in hot springs.
 - Prevent the watch from suffering sudden temperature changes (e.g. drying the watch with a hairdryer).
 - Avoid installing or conducting other operations on the SIM card when the water splashed on the watch has not been properly handled.
 - Avoid exposing the watch to a hydrodynamic environment (e.g. tap water, fountains or toy water guns).
 - Avoid submerging the watch in water for long periods of time.
 - Wipe the sweat on the watch timely.
 - Prevent the watch from falling or being hit as its water resistance may be affected.
 - Avoid contact with any liquid other than water (e.g. white wine, alcohol for pharmaceutical purposes, sea water, acidic substance, detergents, salt water, soapy water, perfumes, insecticide sprays, lotions, sunscreen, etc.).
 - After the watch is exposed to water, wipe it thoroughly with a clean and soft cloth. If the watch is exposed to any liquid other than water, clean and wipe it with a clean and soft cloth moistened with water immediately.
- The watch's water resistance is not permanent and can be effected by the deterioration of the SIM card deck's waterproof silicone ring or by accidental impact on the casing of the watch.
- If the watch is used in water or other liquids, its touch screen and other features may not work.

Attentions for Using Video Call and Camera:

- It is recommended to make video calls when connected to a WLAN network and in a relatively stable signal environment.
- Video calls will consume a lot of power. And the CPU will generate a lot of heat. When the watch's temperature reaches the limit, the protection function will be automatically activated to cut off the video call.
- The watch is equipped with a 2MP camera, but during use, the final image may be less than 2MP.

Personal Information Safety:

- Please use this product with the consent of the wearer. In order to guarantee the safety of your children, please ensure that the watch is not bound by unauthorized persons. We promise to take strict security measures in accordance with the law to protect the security of personal data of your children and you.

Personal Data Processing Tips:

- Please understand that personal data required for the features and/or services of the Watch Phone will be collected and processed during the use of the Watch Phone.

Attentions for Hearing:

- To prevent possible hearing damage, please do not use high sound pressure level and high volume to listen to the sound for a long time.
- When using headphones, it is recommended to use the minimum volume required for music or video, so as not to damage your hearing.
-  Prolonged exposure to high volume may cause permanent hearing damage.

EU&UK Declaration of Conformity (DoC):

- Hereby, IMOO INTERNATIONAL PTE. LTD., declares that this type of equipment is in compliance with the essential requirements and other relevant provisions of Directive 2014/53/EU and UK Radio Equipment Regulations (SI 2017/1206).
- The declaration of conformity may be consulted at:
<https://www.imoo.com/en/pc/certification/index.html>.

Waste Electrical and Electronic Equipment (WEEE):

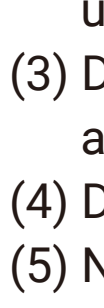
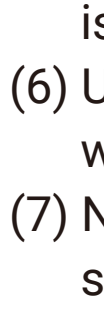
- This symbol means that according to local laws and regulations your product and/or its battery shall be disposed of separately from household waste. When this product reaches its end of life, user has the choice to give his product to a competent recycling organization. Proper recycling of your product will protect human health and the environment.
-  Our company will seek shared responsibility and cooperation from customers in reducing the environmental impact of their products.
-  Our company will comply with all the applicable laws related to WEEE management.

CE&UK Certification Information (SAR):

- The Watch Phone has been tested and it complies with applicable requirements and regulations of EU Human Exposure to RF Fields.
 - To maintain compliance with RF exposure requirements, when placing the watch near your face, keep at least 10 mm to ensure that the exposure level is maintained at or below the test level. And it is unnecessary to leave space between the watch and your wrist.
- W1923AO:
- | | |
|-----------|---|
| CE&UK SAR | 0.826W/kg (Front to face)
1.345W/kg (Wrist Worn) |
|-----------|---|
- W2123AO:
- | | |
|-----------|---|
| CE&UK SAR | 1.39W/kg (Front to face)
1.41W/kg (Wrist Worn) |
|-----------|---|

14. Warranty Descriptions

Service Terms:

- Thank you for choosing our product. We will provide comprehensive service assurance in accordance with local rules and regulations. In case of any inconsistency or omission with local policies, the local policies shall prevail.
- Within 14 days from the date of sale, users can choose product replacement or return for performance fault (not caused by human factors) of the main machine.
 - Within 24 months from the date of sale, users can enjoy warranty service for performance fault under normal use.
 - The information filled in the warranty card should be complete, accurate and convincing. Customer should ask for a valid purchase invoice and keep it properly.
 - The premise of requesting warranty service is to have a valid warranty card and purchase invoice (The information filled in the valid warranty card and purchase invoice should be complete, accurate and without alterations). If the valid warranty card and purchase invoice are lost and a copy of the valid invoice cannot be provided, a 24-month warranty service will be provided since the 90th day after the date of production of the Watch Phone.
 - We provide a 6-month (from the date of sale) replacement service for the charging cable. Other accessories (such as watch strap, manual, etc.) do not enjoy the warranty service.

Warranty Descriptions and Attentions:

- The warranty service is only valid under normal use of the watch. For the cases as below, we do not provide warranty service but provide repair requiring an extra charge.
 - Exceeded the warranty period;
 - Damage caused by human factors, including damage caused by the user's failure in using, operating or keeping the product as required by the manual;
 - Damage caused by repairing, dismantling and modification of service outlets not authorized by the company;
 - Damage caused by natural disasters (e.g. flood, fire, earthquake, lightning, etc.);
 - No valid warranty card or purchase invoice (except those that can prove the product is under warranty);
 - Unauthorized alterations of the warranty card; or the product model or code on the warranty certificate is inconsistent with the real product;
 - Natural wear and tear during use (e.g. case, watch strap, watch buckle, display screen, etc.);
 - Damages on the motherboard or card deck caused by using self-cutting SIM card;
 - Errors, damages and defects that not caused by the quality of the product (e.g. improper use, moisture, deformation, etc.);
 - Fault caused by network or wireless information service provider (operator) is not covered by the warranty.
- Any oral agreement made by the dealer regarding the warranty contents, which is beyond the scope of this warranty agreement, shall not be included in the scope of warranty.
- For products in need of repair, you can go to the nearest imoo official service center for replacement. During replacement, if the main machine is damaged, you can replace it with a new one of the same model; if the accessory is damaged, you can replace it. Both the replacements of the main machine and accessories are for free.
- All parts, components and accessories replaced within the warranty are owned by the company.

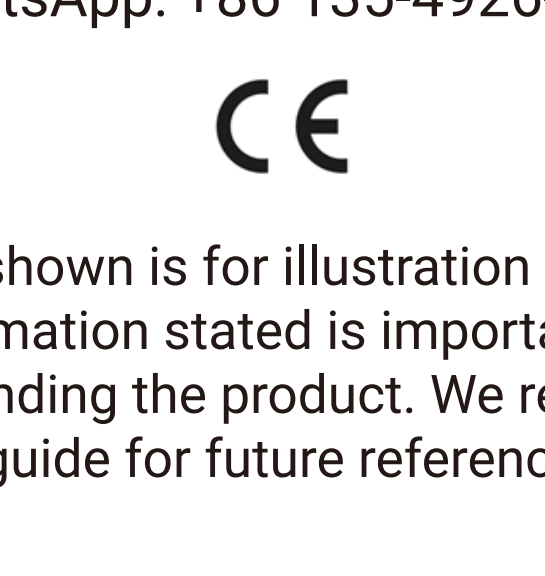

Email: support@imoo.com
WhatsApp: +86 135-4926-5882



The image shown is for illustration purpose only.

Important: Information stated is important for successful application and understanding the product. We recommend you to keep this guide for future reference.